

ROCKWOOD
ROO, MINI LITE, ULTRA LITE &
SIGNATURE TRAVEL TRAILERS

ROCKWOOD

**ROO, MINI LITE, ULTRA LITE &
SIGNATURE TRAVEL TRAILERS**

PROVIDING OUTDOOR FUN SINCE 1974.





OVER 40 YEARS OF EXCELLENCE



FROM HUMBLE BEGINNINGS, ROCKWOOD HAS EMERGED AS AN INDUSTRY LEADER IN THE MANUFACTURING OF LIGHT WEIGHT TRAVEL TRAILERS, TRAVEL TRAILERS AND CAMPING TRAILERS.

Located in Millersburg, IN since 1974, Rockwood has been supported by this community and the local families residing there. These families have helped provide the hundreds of workers that have brought their dedication to quality workmanship, respect for their fellow workers and a commitment to an uncompromising work ethic to make a major contribution to this company's success. Founded on the principle of providing superior value and service while remaining in tune with customer's preferences, Rockwood has become the ultimate luxury product in the light weight travel trailer market, proudly showcasing more innovative floor plans, appealing features and refined interior appointments than any others in its class.

TODAY, ROCKWOOD REMAINS COMMITTED TO INSURING THAT OUR CUSTOMERS ENJOY THEIR CAMPING EXPERIENCES. Through the utilization of our experienced work force, "state of the art" lamination facility, modern production plants and detailed assembly processes our aim is to continue to provide our customers with the best built product possible at an unmatched value.

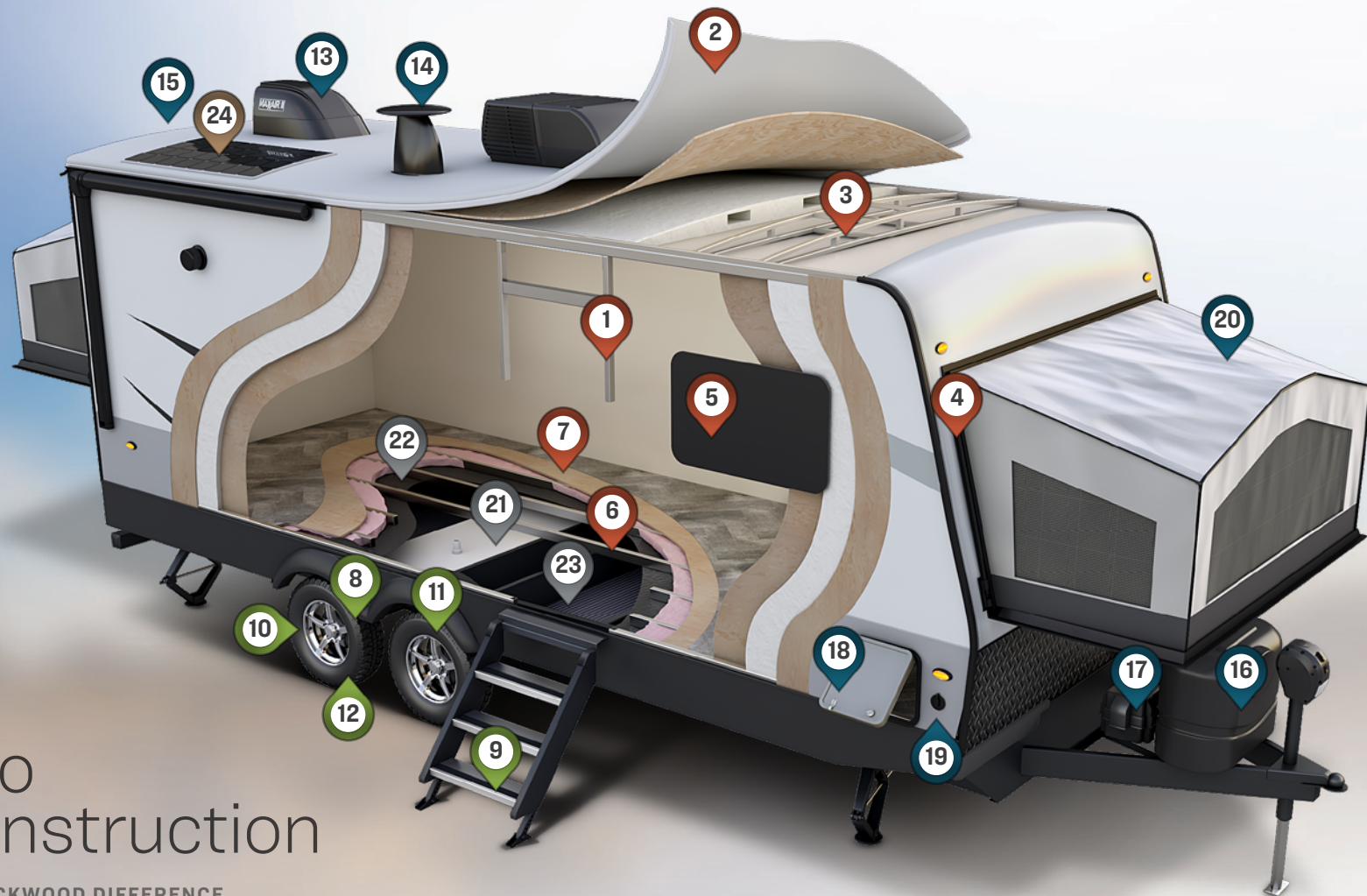

Roo Construction

THE ROCKWOOD DIFFERENCE

SUPERIOR CONSTRUCTION

- 1 6 Sided Full Aluminum Frame
- 2 Fully Laminated One-Piece Walkable Roof
- 3 Aluminum Truss AC Bracing
- 4 Easy Reach Latch System
- 5 Frameless Windows
- 6 Aluminum Floor Joists
- 7 5/8" Tongue & Groove Plywood Floor

SAFETY STANDARDS

- 8 Dexter Torsion Axles
- 9 MORryde Strut Assist Steps (N/A 19/183/233S)
- 10 TST Tire Pressure Monitor System
- 11 Goodyear Endurance Tires
- 12 Nitrogen Filled Tires

STANDARD FEATURES

- 13 2 Maxxair Fans w/ Covers
- 14 Teton All In One WiFi Booster w/ LTE Prep & Antenna
- 15 Back Up Camera Prep
- 16 Double 20# LP Bottles
- 17 Double Battery Boxes
- 18 Key-Alike Locks
- 19 Solar Prep On Side & Roof
- 20 5 Year Tent Warranty

CLIMATE PROTECTION PACKAGE

- 21 4" Block Foam Insulated Roof
- 22 Optional 12v Thermostatically Controlled Heated Tanks
- 23 Radiant Foil Insulated Underbelly

OPTIONAL FEATURES

- 24 190w Solar Panel w/ 1000w Inverter

ROO

A VALUE THAT'LL MAKE YOU JUMP! We have a trailer just for you. Whether you are interested in the expanded interior space provided by the spacious drop down bunks with heated mattresses and the feel of a traditional trailer, the Rockwood Roo will deliver the quality and amenities you expect. Rockwood brings the necessities of residential living on the campsite

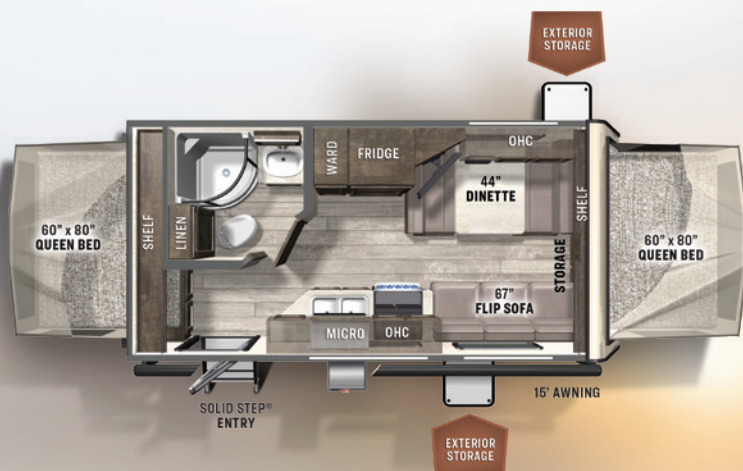

19 EXPANDABLE U/VW: 4137 HITCH: 448 AXLE: 3651 LENGTH: 21'2" OPEN LENGTH: 25'7"
ROO CCC: 1591 WIDTH: 8' HEIGHT: 10'6" FRESH: 54 gal GRAY: 30gal BLACK: 30gal



21SS EXPANDABLE U/VW: 4137 HITCH: 448 AXLE: 3651 LENGTH: 21'2" OPEN LENGTH: 25'7"
ROO CCC: 1591 WIDTH: 8' HEIGHT: 10'6" FRESH: 54 gal GRAY: 30gal BLACK: 30gal



23FK EXPANDABLE U/VW: 4137 HITCH: 448 AXLE: 3651 LENGTH: 21'2" OPEN LENGTH: 25'7"
ROO CCC: 1591 WIDTH: 8' HEIGHT: 10'6" FRESH: 54 gal GRAY: 30gal BLACK: 30gal

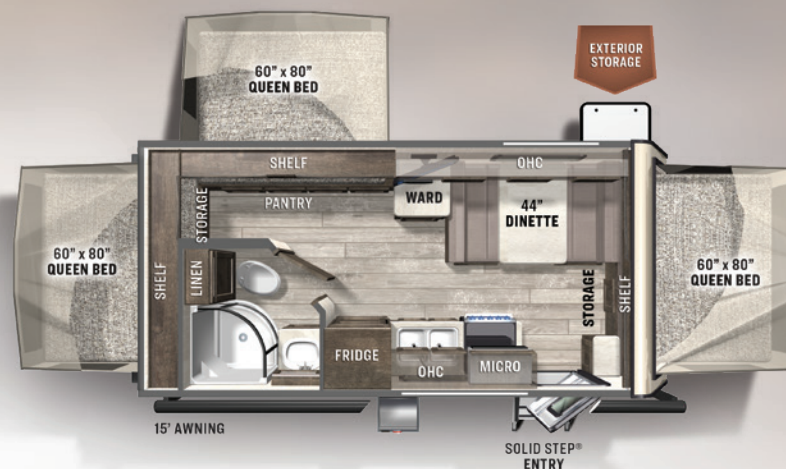

183 EXPANDABLE U/VW: 4137 HITCH: 448 AXLE: 3651 LENGTH: 21'2" OPEN LENGTH: 25'7"
ROO CCC: 1591 WIDTH: 8' HEIGHT: 10'6" FRESH: 54 gal GRAY: 30gal BLACK: 30gal



233S

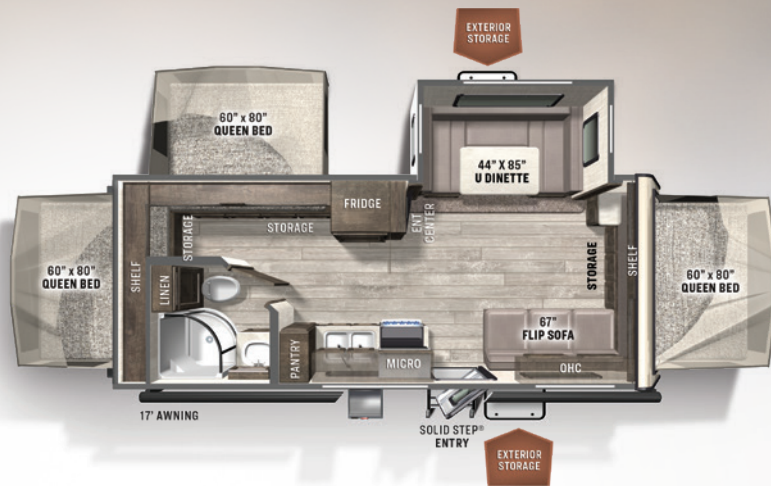

233S

EXPANDABLE U/VW: 5062 HITCH: 650 AXLE: 4374 LENGTH: 24'10" OPEN LENGTH: 29'7"
ROO CCC: 1588 WIDTH: 8' HEIGHT: 10'6" FRESH: 54 gal GRAY: 30 gal BLACK: 30 gal

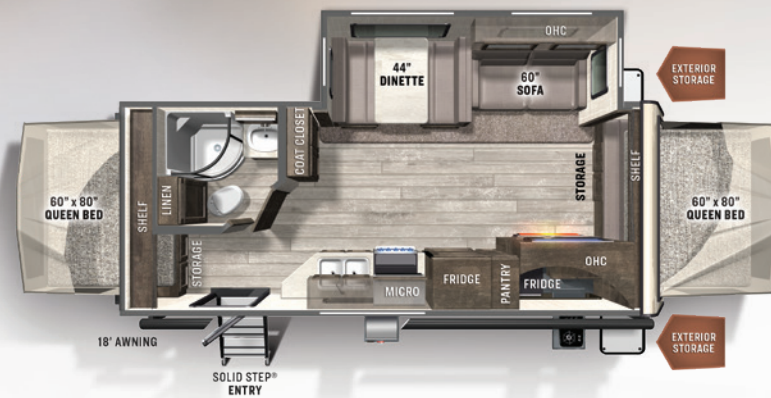

235S

EXPANDABLE U/VW: 5695 HITCH: 732 AXLE: 4925 LENGTH: 24'10" OPEN LENGTH: 29'7"
ROO CCC: 1197 WIDTH: 8' HEIGHT: 10'11" FRESH: 54 gal GRAY: 30 gal BLACK: 30 gal

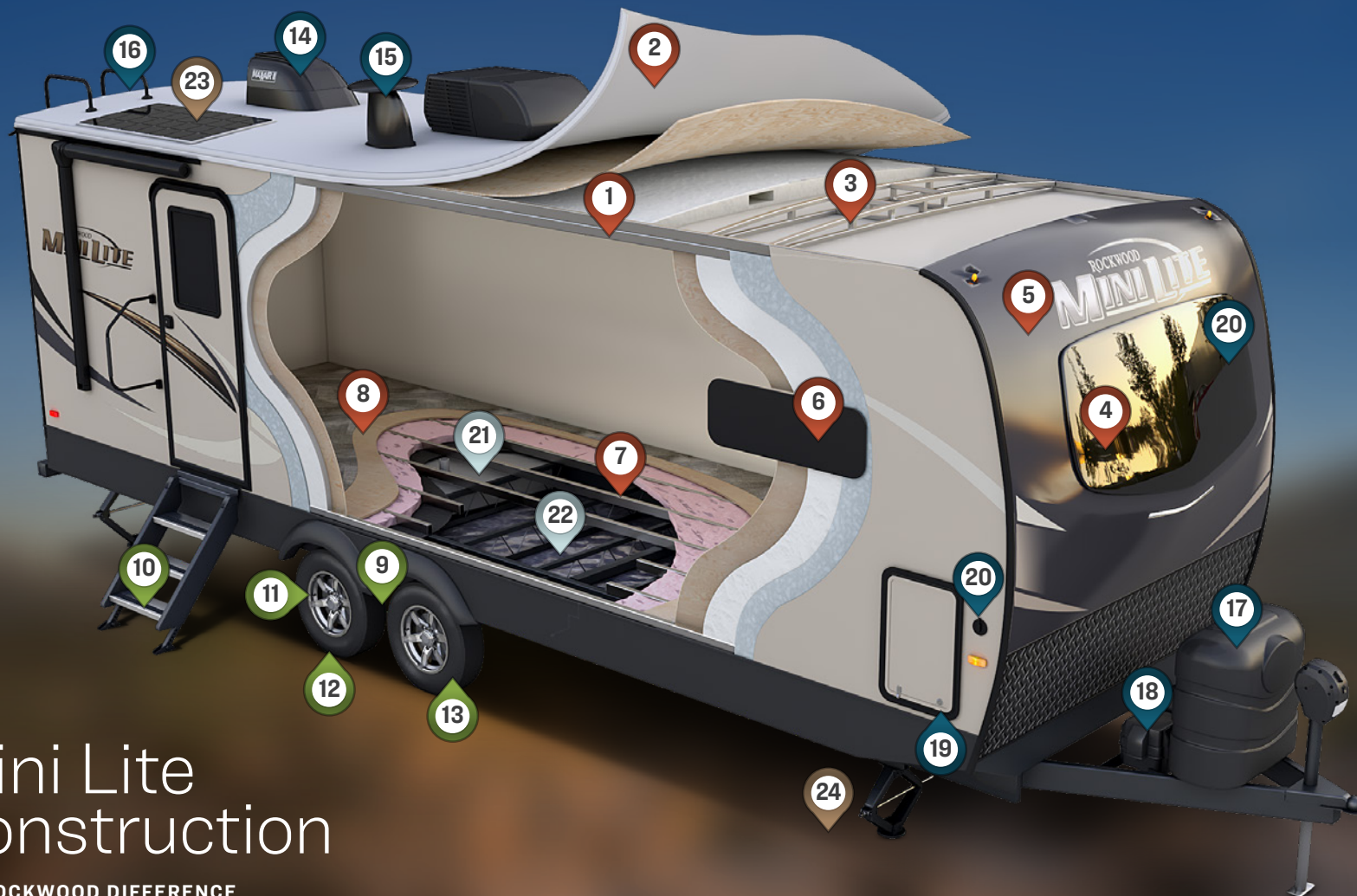

Mini Lite Construction

THE ROCKWOOD DIFFERENCE

SUPERIOR CONSTRUCTION

- 1 6 Sided Full Aluminum Frame
- 2 Fully Laminated One-Piece Walkable Roof
- 3 Aluminum Truss Roof Bracing
- 4 Automotive Glass Windshield
- 5 Painted Fiberglass Front Cap w/ Clear Coat
- 6 Frameless Windows
- 7 Aluminum Floor Joists
- 8 5/8" Tongue & Groove Plywood Floor

SAFETY STANDARDS

- 9 Dexter Torsion Axles
- 10 MORryde Strut Assist Steps (NA 21FBRS)
- 11 TST Tire Pressure Monitor System
- 12 Goodyear Endurance Tires
- 13 Nitrogen Filled Tires

STANDARD FEATURES

- 14 Maxxair Fan w/ Cover
- 15 Teton All In One Wifi Booster w/ LTE Prep & Antenna
- 16 Back Up Camera Prep
- 17 Double 30# LP Bottles
- 18 Double Battery Boxes
- 19 Key-Alike Locks
- 20 Solar Prep On Side & Roof

CLIMATE PROTECTION PACKAGE

- 21 12v Thermostatically Controlled Heated Tanks
- 22 Radiant Foil In Underbelly, Front Caps & Slide Out Floors

OPTIONAL FEATURES

- 23 190w Solar Panel w/ 1000w Inverter
- 24 Power Stabilizers (Not Pictured)



2104S **MURPHY BED** UVW: 4841 HITCH: 614 AXLE: 4168 CCC: 1933 LENGTH: 22' 4"
MINI LITE WIDTH: 8' HEIGHT: 10' 11" **FRESH: 54 gal** **GRAY: 30 gal** **BLACK: 30 gal**



2109S **REAR LIVING** UVW: 4171 HITCH: 412 AXLE: 3700 CCC: 1521 LENGTH: 22' 4"
MINI LITE WIDTH: 8' HEIGHT: 10' 3" **FRESH: 54 gal** **GRAY: 30 gal** **BLACK: 30 gal**



2205S **REAR LIVING** UVW: 5004 HITCH: 530 AXLE: 4415 CCC: 1686 LENGTH: 23' 10"
MINI LITE WIDTH: 8' HEIGHT: 10' 11" **FRESH: 54 gal** **GRAY: 30 gal** **BLACK: 30 gal**

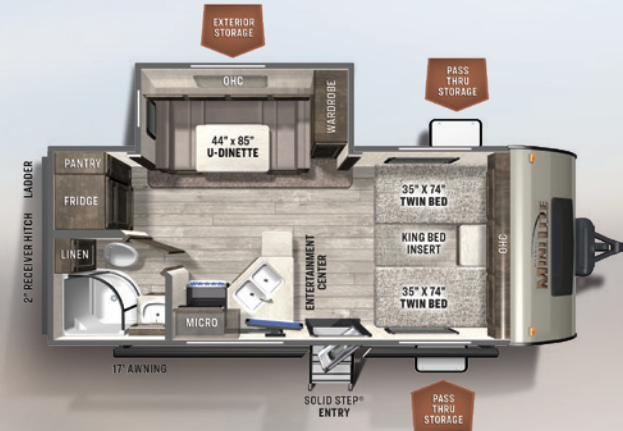

2204S **TWIN BED** UVW: 4795 HITCH: 640 AXLE: 4096 CCC: 2005 LENGTH: 23' 11"
MINI LITE WIDTH: 8' HEIGHT: 10' 11" **FRESH: 54 gal** **GRAY: 30 gal** **BLACK: 30 gal**



2507S **MURPHY BED** UVW: 5471 HITCH: 625 AXLE: 4787 CCC: 1314 LENGTH: 25' 10"
MINI LITE WIDTH: 8' HEIGHT: 10' 11" **FRESH: 54 gal** **GRAY: 30 gal** **BLACK: 30 gal**

MINI LITE

TOWING A TRAILER DOESN'T REQUIRE A TRUCK ANYMORE. When towing size and weight are your focus, you will find that these specially designed Mini Lite models offer flexible floor plans that provide you with more comfort and amenities than you would expect — all within the towing capacity of many SUV's.



2509S



2509S



2509S	MURPHY BED	UVW: 5300	HITCH: 709	AXLE: 4532	CCC: 1569	LENGTH: 25'11"
	MINI LITE	WIDTH: 8'	HEIGHT: 10'11"	FRESH: 54 gal	GRAY: 30 gal	BLACK: 30 gal



2513S	REAR LIVING	UVW: 5894	HITCH: 725	AXLE: 5110	CCC: 1831	LENGTH: 25'10"
	MINI LITE	WIDTH: 8'	HEIGHT: 10'11"	FRESH: 54 gal	GRAY: 30 gal	BLACK: 30 gal



2511S **REAR LIVING** UVW: 5492 HITCH: 714 AXLE: 4719 CCC: 1382 LENGTH: 25'10"
MINI LITE WIDTH: 8' HEIGHT: 10'11" FRESH: 54 gal GRAY: 60 gal BLACK: 30 gal

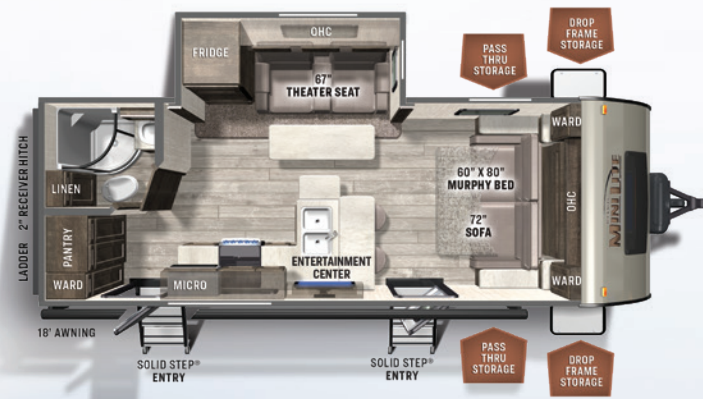

2514S **MURPHY BED** UVW: 5879 HITCH: 585 AXLE: 5235 CCC: 1706 LENGTH: 25'10"
MINI LITE WIDTH: 8' HEIGHT: 10'11" FRESH: 54 gal GRAY: 30 gal BLACK: 30 gal



2516S **FRONT KITCHEN** UVW: 6033 HITCH: 810 AXLE: 5164 CCC: 1777 LENGTH: 25'11"
MINI LITE WIDTH: 8' HEIGHT: 10'11" FRESH: 54 gal GRAY: 60 gal BLACK: 30 gal

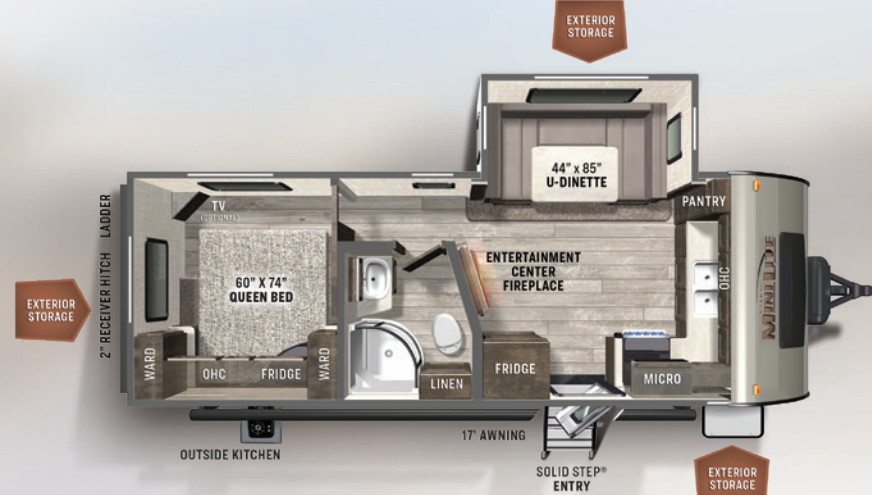

2506S **FRONT KITCHEN** UVW: 5281 HITCH: 644 AXLE: 4510 CCC: 1523 LENGTH: 25'11"
MINI LITE WIDTH: 8' HEIGHT: 10'11" FRESH: 54 gal GRAY: 60 gal BLACK: 30 gal



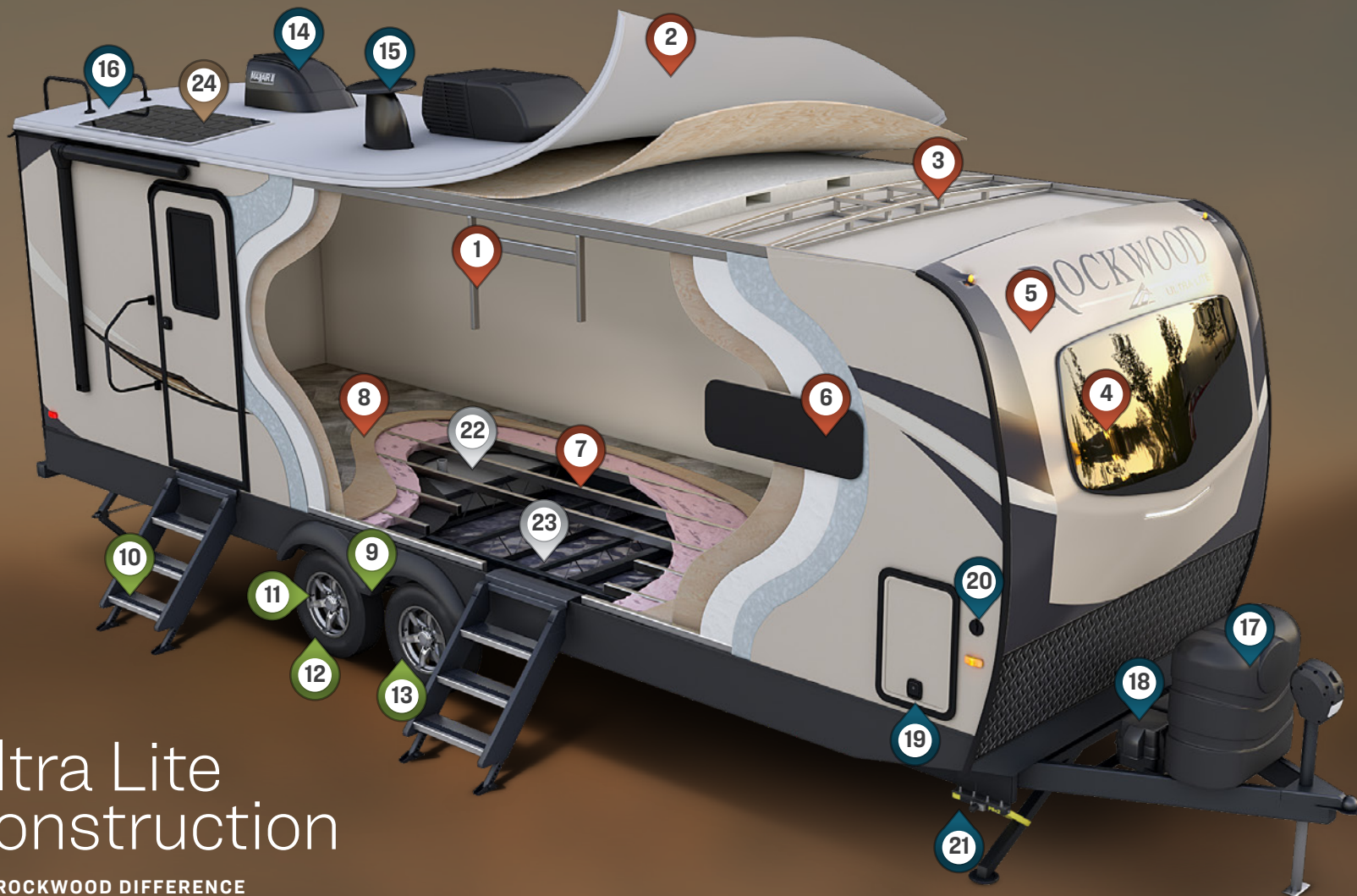

Ultra Lite Construction

THE ROCKWOOD DIFFERENCE

SUPERIOR CONSTRUCTION

- 1 6 Sided Full Aluminum Frame
- 2 Fully Laminated One-Piece Walkable Roof
- 3 Aluminum Truss Roof Bracing
- 4 Automotive Glass Windshield
- 5 Painted Fiberglass Front Cap w/ Clear Coat
- 6 Frameless Windows
- 7 Aluminum Floor Joists
- 8 5/8" Tongue & Groove Plywood Floor

SAFETY STANDARDS

- 9 Dexter Torsion Axles
- 10 MORryde Strut Assist Steps
- 11 TST Tire Pressure Monitor System
- 12 Goodyear Endurance Tires
- 13 Nitrogen Filled Tires

STANDARD FEATURES

- 14 Maxxair Fan w/ Cover
- 15 Teton All In One Wifi Booster w/ LTE Prep & Antenna
- 16 Back Up Camera Prep
- 17 Double 30# LP Bottles
- 18 Double Battery Boxes
- 19 Key-Alike Locks
- 20 Solar Prep On Side & Roof
- 21 Power Stabilizers

CLIMATE PROTECTION PACKAGE

- 22 12v Thermostatically Controlled Heated Tanks
- 23 Radiant Foil In Underbelly, Front Caps & Slide Floors

OPTIONAL FEATURES

- 24 190w Solar Panel w/ 1000w Inverter



ULTRA LITE

YOU'LL LOVE WHAT YOU FIND IN OUR FLOOR PLANS. Our trailers are packed full of quality features in order to bring to you one of the best values in the light weight market. There are spacious flush floor slides, comfortable stylish sofas and wide dinettes. Our Ultra Lite series offers lots of room and amenities while still being a 1/2 ton towable Travel Trailer.



26FKBS



2606WS **REAR LIVING** UVW: 6158 HITCH: 908 AXLE: 5191 CCC: 2550 LENGTH: 29'9"
SUPER LITE WIDTH: 8' HEIGHT: 11'2" **FRESH: 54 gal** **GRAY: 90 gal** **BLACK: 45 gal**



2608BS **FRONT KITCHEN** UVW: 6836 HITCH: 946 AXLE: 5831 CCC: 1910 LENGTH: 29'8"
SUPER LITE WIDTH: 8' HEIGHT: 11'2" **FRESH: 54 gal** **GRAY: 90 gal** **BLACK: 45 gal**



2613BS **REAR LIVING** UVW: 6988 HITCH: 796 AXLE: 6133 CCC: 1608 LENGTH: 29'9"
SUPER LITE WIDTH: 8' HEIGHT: 11'2" **FRESH: 54 gal** **GRAY: 90 gal** **BLACK: 45 gal**



2614BS **REAR KITCHEN** UVW: 6988 HITCH: 796 AXLE: 6133 CCC: 1608 LENGTH: 29'9"
SUPER LITE WIDTH: 8' HEIGHT: 11'2" **FRESH: 54 gal** **GRAY: 90 gal** **BLACK: 45 gal**



2706WS

BUNK HOUSE	UVW: 7310	HITCH: 921	AXLE: 6330	CCC: 1411	LENGTH: 32'10"
SUPER LITE	WIDTH: 8'	HEIGHT: 11'2"	FRESH: 54 gal	GRAY: 90 gal	BLACK: 45 gal



2720IK

REAR KITCHEN	UVW: 6158	HITCH: 908	AXLE: 5191	CCC: 2550	LENGTH: 29'9"
SUPER LITE	WIDTH: 8'	HEIGHT: 11'2"	FRESH: 54 gal	GRAY: 90 gal	BLACK: 45 gal

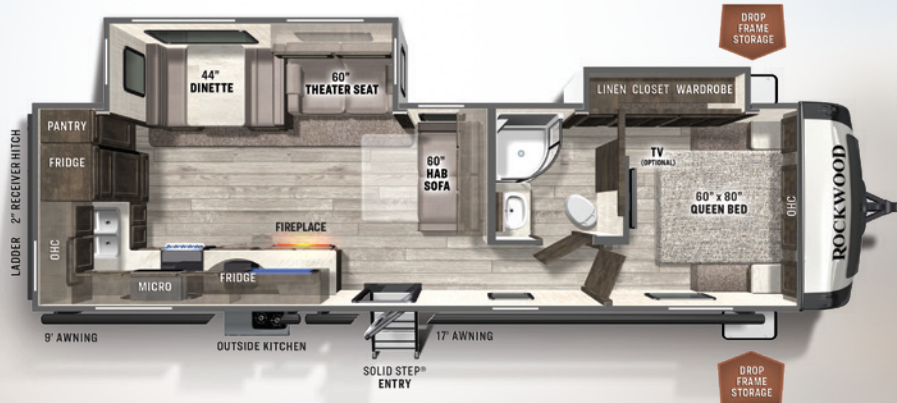

2902SW

REAR KITCHEN	UVW: 7310	HITCH: 921	AXLE: 6330	CCC: 1411	LENGTH: 32'10"
SUPER LITE	WIDTH: 8'	HEIGHT: 11'2"	FRESH: 54 gal	GRAY: 90 gal	BLACK: 45 gal



2906BS

REAR LIVING	UVW: 7310	HITCH: 921	AXLE: 6330	CCC: 1411	LENGTH: 32'10"
SUPER LITE	WIDTH: 8'	HEIGHT: 11'2"	FRESH: 54 gal	GRAY: 90 gal	BLACK: 45 gal



2911SB

BUNK HOUSE	UVW: 6988	HITCH: 796	AXLE: 6133	CCC: 1608	LENGTH: 29'9"
SUPER LITE	WIDTH: 8'	HEIGHT: 11'2"	FRESH: 54 gal	GRAY: 90 gal	BLACK: 45 gal



2912BS

REAR LIVING	UVW: TBD	HITCH: 1555	AXLE: 8326	CCC: TBD	LENGTH: TBD
SUPER LITE	WIDTH: TBD	HEIGHT: TBD	FRESH:	GRAY:	BLACK:

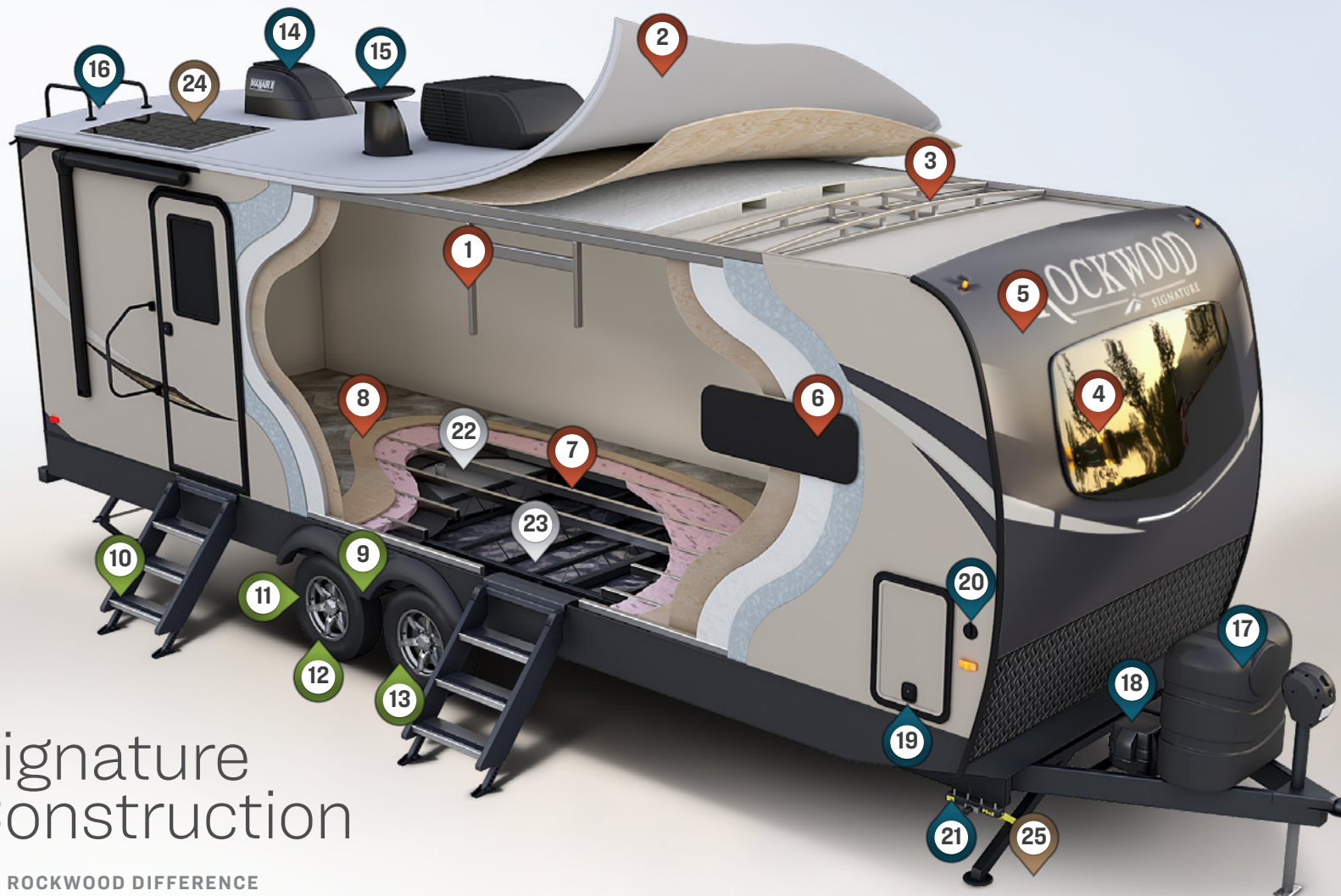

Signature Construction

THE ROCKWOOD DIFFERENCE

SUPERIOR CONSTRUCTION

- 1 6 Sided Full Aluminum Frame
- 2 Fully Laminated One-Piece Walkable Roof
- 3 Aluminum Truss Roof Bracing
- 4 Automotive Glass Windshield
- 5 Painted Fiberglass Front Cap w/ Clear Coat
- 6 Frameless Windows
- 7 Aluminum Floor Joists
- 8 5/8" Tongue & Groove Plywood Floor

SAFETY STANDARDS

- 9 Dexter Torsion Axles
- 10 MORryde Strut Assist Steps
- 11 TST Tire Pressure Monitor System
- 12 Goodyear Endurance Tires
- 13 Nitrogen Filled Tires

STANDARD FEATURES

- 14 Maxxair Fan w/ Cover
- 15 Teton All In One Wifi Booster w/ LTE Prep & Antenna
- 16 Back Up Camera Prep
- 17 Double 30# LP Bottles
- 18 Double Battery Boxes
- 19 Key-Alike Locks
- 20 Solar Prep On Side & Roof
- 21 PSX2 Power Stabilizers

CLIMATE PROTECTION PACKAGE

- 22 12v Thermostatically Controlled Heated Tanks
- 23 Radiant Foil In Underbelly, Front Caps & Slide Out Floors

OPTIONAL FEATURES

- 24 190w Solar Panel w/ 1000w Inverter
- 25 Electric Auto-leveling



8263MBR

SUITE SERIES	UVW: 7809	HITCH: 1065	AXLE: 6685	CCC: 2056	LENGTH: 29'11"
SIGNATURE	WIDTH: 8'	HEIGHT: 11'7"	FRESH: 54 gal	GRAY: 95 gal	BLACK: 40 gal

8335SB

SIGNATURE

BEAUTIFUL SPACIOUS INTERIORS COME STANDARD. THE SIGNATURE SERIES HAS MANY OUTSTANDING FEATURES TO ENHANCE YOUR CAMPING EXPERIENCE. The open floorplans and generous storage space allows extra room for those extra things you want to bring along. Sleeping on the comfortable bed, you'll forget you were in the great outdoors. The spacious interior and picturesque view through the many windows enable you to experience your surroundings in the comfort of your Signature travel trailer.



8336BH

BUNKHOUSE	UVW: 9669	HITCH: 1320	AXLE: 8290	CCC: 1651	LENGTH: 36'8"
SIGNATURE	WIDTH: 8'	HEIGHT: 11'7"	FRESH: 54 gal	GRAY: 130 gal	BLACK: 50 gal

8329SB



8335SB FRONT KITCHEN SIGNATURE UVW: 8327 HITCH: 1057 AXLE: 7211 CCC: 2730 LENGTH: 36'8" WIDTH: 8' HEIGHT: 11'7" FRESH: 54 gal GRAY: 130 gal BLACK: 50 gal

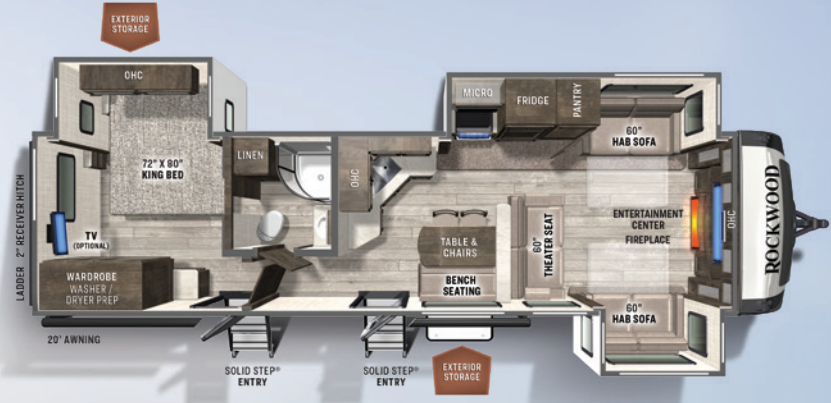

8324SB FRONT LIVING SIGNATURE UVW: 9254 HITCH: 1115 AXLE: 8080 CCC: 1861 LENGTH: 36'8" WIDTH: 8' HEIGHT: 11'7" FRESH: 54 gal GRAY: 120 gal BLACK: 50 gal



8337RL REAR LIVING SIGNATURE UVW: 9209 HITCH: 1315 AXLE: 7835 CCC: 2106 LENGTH: 36'8" WIDTH: 8' HEIGHT: 11'7" FRESH: 54 gal GRAY: 120 gal BLACK: 50 gal



8329SB REAR KITCHEN SIGNATURE UVW: 8839 HITCH: 1130 AXLE: 7650 CCC: 2291 LENGTH: 36'8" WIDTH: 8' HEIGHT: 11'7" FRESH: 54 gal GRAY: 80 gal BLACK: 50 gal



8332SB REAR KITCHEN SIGNATURE UVW: 9444 HITCH: 1130 AXLE: 8255 CCC: 1686 LENGTH: 36'8" WIDTH: 8' HEIGHT: 11'7" FRESH: 54 gal GRAY: 110 gal BLACK: 50 gal



CAI. THIS IS OUR FINE TOOTH COMB.

CAI (CUSTOMER ASSURANCE INSPECTION) Each Rockwood production line has a complete online PDI staff that is responsible for double checking all function and code test on every Rockwood Trailer. CAI is an independent facility that takes Rockwood trailers from each line and inspects them to ensure that the online PDI staff and system is functioning to the standards that Rockwood has set along with all governing code groups. This ensures we are putting the best product into the hands of our selling dealers.

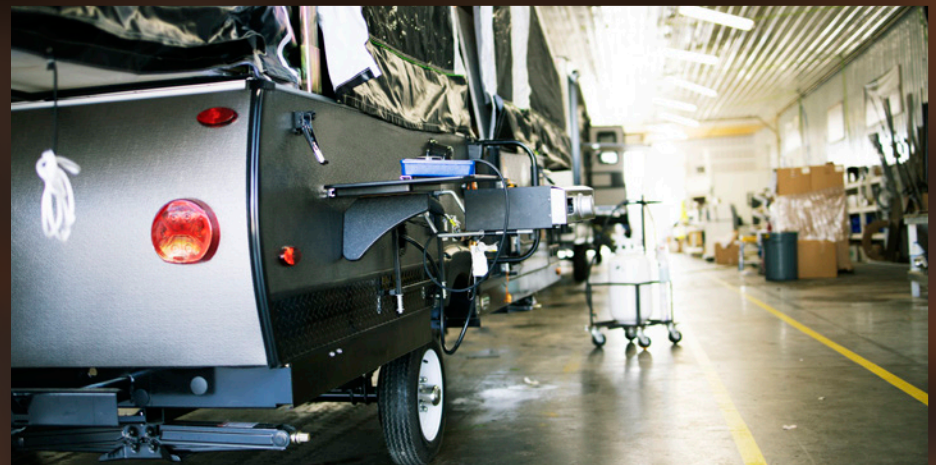



- A Rear camera prep.** (Std. all models) The Furrion observation camera system with digital wireless technology is sold separately.
- B 2" Accessory Hitch Receiver** (Std.) 300 LB capacity
- C Teton All In One WiFi Booster/ LTE Prep & Antenna**
- D OneControl App Controlled Switch Panel** (N/A Signature)
- E Tire Pressure Monitoring System** (Std.)
- F Roof & Side Solar Panel Prep** (Std. All Models) The Zamp 40 amp. portable solar panel shown is sold separately.
- G Hide-A-Bed Sofa.** Fabric matched to decor.
- H Swivel Rocker Recliner** where applicable. Fabric to match. (Standard on 8329SB only.)
- I La-Z-Boy Swivel Recliner** where applicable. Fabric to match. (Optional on 8329SB & 8337RL.)
- J 67" Theatre Seating** per plan where available. Fabric matched to decor. (Per floorplan)

CHOCOLATE

SOFA, CHAIRS, DINETTE CUSHIONS
(LEATHER APPEARANCE)
(SEAPORT MINK)

ACCENTS
(BUREN BK CASHMERE)



BEDROOM (DODWORTH COBBLESTONE)



SLATEWOOD
STANDARD

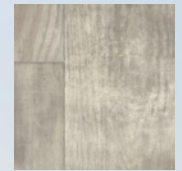

FLOOR COVERING
WITH SLATEWOOD



NEWPORT ASH
OPTIONAL

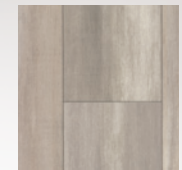

FLOOR COVERING
WITH NEWPORT ASH



CARPET

STONE

SOFA, CHAIRS, DINETTE CUSHIONS
(LEATHER APPEARANCE)
(XANDER STONE)

ACCENTS (LUZ BK MINERAL)



BEDROOM (DODWORTH COBBLESTONE)

STANDARDS & OPTIONS

20

MINI LITE OPTIONS
Laminated White Fiberglass Sidewalls
Newport Ash Interior
15,000 BTU A/C
Bedroom Mounted LED TV (Select Floor Plans)
Deluxe Tri-Fold Sleeper Sofa (Per Floor Plans)
Extra Maxxair® Ventilation Fan and Vent Cover
Bike Rack Ladder Attachment
Tongue Mount Bike Rack
Slide Topper
ThermoPane Windows
190W Roof Solar Panel with 1000W Inverter
Sport, Tire and Wheel Package
12V Fridge with 190W Roof Solar Panel with 1000W Inverter
Night Roller Shades
Power Stabilizer Jacks
Free Standing Table & Chairs (Per Floor Plan)
Theater Seating IPO Dinette

ULTRA LITE FEATURES
Laminated Champagne Fiberglass Sidewalls
35K BTU Furnace
Solid Surface Kitchen Countertops
Power Stabilizer Jacks
Designer Kitchen Backsplash
Automotive Windshield
Rear Ladder
Night Roller Shades
50 Amp Service and Digital Dual
Thermostat Control

ULTRA LITE OPTIONS
Laminated White Fiberglass Sidewalls
Newport Ash Interior
15,000 BTU A/C
2nd Roof 13,500 BTU A/C with Chill Chaser
Heat Strip
Bedroom TV & Bunkroom TV
Theatre Seating w/ Cup Holders, USB Charger & Lumbar Support (Per Floor Plan)
Free Standing Table and Chairs (Per Floor Plan)
Bike Rack Ladder Attachment
Tongue Mount Bike Rack
Slide Toppers
Thermopane Windows
Day/Night Roller Shade
12V Refrigerator w/ Inverter and Roof Solar Panel
190W Roof Solar Panel with 1000W Inverter
King Bed IPO 2720IK, 2906BS, 2912BS
Bedroom Carpet

SIGNATURE FEATURES
High Gloss Laminated Champagne Fiberglass Sidewalls
35K Ducted BTU Furnace
86" Interior Height
High Gloss Front Cap with Automotive Windshield (NA 8332SB)
13,500 BTU Ducted A/C w/ 50 AMP Service & Prepped for 2nd A/C
Upgraded 21" Gas Oven
Residential Full Extension Soft Close Drawers
Extra Large Double Door 2 Way Refrigerator
Residential Solid Surface Kitchen Countertops
Designer Kitchen Backsplash
Flush Mount Stainless Steel Sinks w/ Cover & Pull Down Faucets
Upgraded Sound Bar with Sub Woofer
Touch Button Control Panel w/ App Control
Rear Ladder
Day/Night Roller Shades
Shielded Awning Cover
Power Stabilizer Jacks
Upgraded Backlit Headboard

SIGNATURE OPTIONS
Laminated White Fiberglass Sidewalls
Newport Ash Interior
Bedroom Carpet
15,000 BTU Ducted Roof Air
2nd AC in Bedroom with Digital Dual Control Thermostat
2nd HAB Sofa in Bunkroom
Theatre Seating Available IPO Standard Recliner or HAB sofa (Per Floor Plan)
Free Standing Table and Chairs (Per Floor Plan)
20 Cubic Foot Residential Refrigerator w/ Inverter (Select Floor Plans)
12V Fridge with 190W Roof Solar Panel with 1000W Inverter
Extra Maxxair® Ventilation and Vent Cover
Bike Rack Ladder Attachment
Tongue Mount Bike Rack
Slide Toppers
Sliding Glass Padio Door (8335SB Only)
ThermoPane Window Upgrade
La-Z-Boy Recliners (per floorplan)
Electric Auto Leveling System
LED Bedroom TV
Bunkroom Entertainment Package
Washer/Dryer (Per Floor Plan)
190W Roof Solar Panel with 1000W Inverter
Flip Down Rear Storage Deck (250 lbs. Max Load)



We work hard to make a quality product
So you can enjoy it for years to come.

Rockwood Warranty. Our Promise.

FOR DETAILS ON ROCKWOOD'S COMPLETE WARRANTY PROGRAM, SEE YOUR ROCKWOOD DEALER. When it comes to backing products with the same quality and commitment it does when it begins the manufacturing process, the only name you have to remember when you're looking for a recreational vehicle is Rockwood. Rockwood offers the following additional limited warranties to the original purchasers. Consult written warranty for details.

1. Twelve-year vinyl roof warranty.
2. Two-year fiberglass warranty.
3. Ten-year Torflex® axle warranty.
4. One-year bumper to bumper warranty.
5. Five-year tent warranty



www.ForestRiverBuyLocal.com



24/7 EMERGENCY ROADSIDE ASSISTANCE WITH VEHICLE PURCHASE*

TOWING
JUMP-STARTS
TIRE CHANGES
FLUID DELIVERY
LOCKOUT
SERVICE

WINCH-OUT
MOBILE MECHANIC
TECHNICAL
SUPPORT
DEALER LOCATOR
SERVICES



*VALID FOR 1 YEAR FROM DATE OF PURCHASE



PRE-DELIVERY INSPECTION FACILITY

20,000 square feet of quality assurance. The bare essentials for a premium product. This state-of-the-art facility gives immediate daily feedback to production for quality assurance in every unit built.

Specification Definitions :: GVWR (Gross Vehicle Weight Rating) - is the maximum permissible weight of the unit when fully loaded. It includes all weights, inclusive of all fluids, cargo, optional equipment and accessories. For safety and product performance do NOT exceed the GVWR. // **GAWR (Gross Axle Weight Rating)** - is the maximum permissible weight, including cargo, fluids, optional equipment and accessories that can be safely supported by a combination of all axles. // **UVW (Unloaded Vehicle Weight)** - is the typical weight of the unit as manufactured at the factory. It includes all weight at the unit's axle(s) and tongue or pin and LP Gas. The UVW does not include cargo, fresh potable water, additional optional equipment or dealer installed accessories. *Estimated average based on standard build optional equipment. // **CCC (Cargo Carrying Capacity)** - is the amount of weight available for fresh potable water, cargo, additional optional equipment and accessories. CCC is equal to GVWR minus UVW. Available CCC should accommodate fresh potable water (8.3 lbs per gallon). Before filling the fresh water tank, empty the black and gray tanks to provide for more cargo capacity. ** Estimated average based on standard build optional equipment. // Each Forest River RV is weighed at the manufacturing facility prior to shipping. A label identifying the unloaded vehicle weight of the actual unit and the cargo carrying capacity is applied to every Forest River RV prior to leaving our facilities. The load capacity of your unit is designated by weight, not by volume, so you cannot necessarily use all available space when loading your unit. // All information contained in this brochure is believed to be accurate at the time of publication. However, during the model year, it may be necessary to make revisions and Forest River, Inc., reserves the right to make all such changes without notice, including prices, colors, materials, equipment and specifications as well as the addition of new models and the discontinuance of models shown in this brochure. Therefore, please consult with your Forest River dealer and confirm the existence of any materials, design or specifications that are material to your purchase decision. Litho. U.S.A. FOR 1763 P&W: 2020.12.07

Look for our other popular
lines of Rockwood trailers.



ROCKWOOD GEO PRO



ROCKWOOD FIFTH WHEELS



ROCKWOOD TENT CAMPERS

YOUR **ROCKWOOD** DEALER



Learn More
Scan this barcode using
a QR Reader on your
smart phone to learn
more about Forest River.



A Berkshire Hathaway company.

